





LED TUBES INSTALLATION

Instructions for Led T8 tubes installation 435-600-970-1200-1500 mm in compliance with regulations EN/IEC 62776

 <p>LED Starter</p> <p>Starter Led lamp</p>	 <p>The lamp must be installed in dry environments otherwise you better use a correct fixture</p>
 <p>Not dimmable lamp</p>	 <p>The lamp must not be used in fixtures planned for emergency lighting</p>

T8 Fluorescent tubes replacement with T8 Led tubes

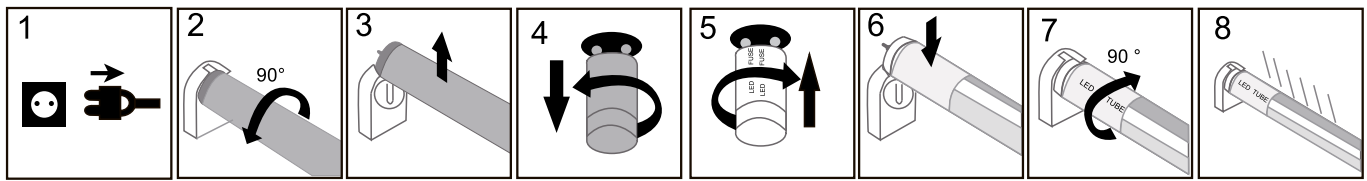

1. Disconnect power supply
2. Turn the fluorescent tube 90 degrees anti-clockwise
3. Remove the fluorescent tube
4. Remove the starter
5. Put the starter Led in place of the original starter
6. Put the Led tube in the lamp holder
7. Turn the Led tube 90° degrees clockwise
8. Give supply and verify Led tube starting

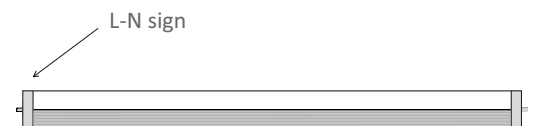

standard electric circuit of fluorescent tube

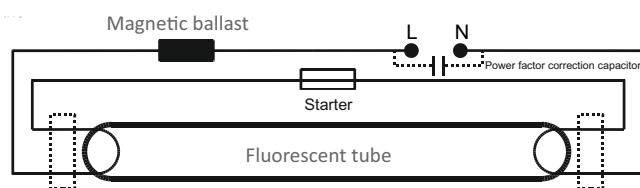

electric circuit with Led tube

